

PERMIT

CITY OF NAPOLEON, OHIO — DEPT. OF BUILDING & ZONING
255 W. Riverview Avenue, Napoleon, Ohio 43545 (419) 592-4010

Permit No. 379 Date 10-29-81
Job Location 906 S. Perry St. Valuation \$ 900.00
Owner K.M. Lighthill Address 906 S. Perry St
Contractor Eldor Gerken Telephone No. 267-3373
Address Ridgeville Corners
Electric Contractor _____
Plumbing Contractor Same
Mechanical Contractor _____

This permit is issued for work described in the plans, specifications, and/or application submitted, as approved by the Building Commissioner of the City of Napoleon, Ohio. Work shall conform to all pertinent construction and land use Codes and Ordinances.

Work Information:

Residential 1X Commercial _____ Industrial _____
No. dwelling units
New Construction _____ Addition _____ Remodel _____
Brief Description of Work New 100,000 B.T.U. furnace, 6 new heat runs

ISSUED BY Richard Haymer DEPT. OF BUILDING & ZONING
Building Official JRC

It is the owners or contractors responsibility to call the Building Department for the following (x) inspections:

- _____ Footing excavation prior to placing concrete.
- _____ Footing drains and foundation prior to backfill.
- _____ Prepared sub-grade prior to placing concrete floor slab.
- _____ Sanitary sewer
- _____ Rough-in electrical, plumbing and service framing prior to installing wall board.
- X Final electrical, plumbing and heating.
- _____ Final building inspection, prior to occupancy.

PERMIT & FEES

Building Permit	\$ _____
Electrical Permit	\$ _____
Plumbing Permit	\$ _____
Mechanical Permit	\$ <u>6.00</u>
Demolition Permit	\$ _____
Zoning Permit	\$ _____
Sign Permit	\$ _____
Water Tap	\$ _____
Sewer Tap	\$ _____
Temp. Elec.	\$ _____
Other	\$ _____

TOTAL FEES \$ 6.00
LESS FEES PAID \$ _____
BALANCE DUE \$ _____

Permit is not valid until all fees are paid in full, and shall be void if work is not started within six months of date above.

PAID
OCT 27 1981
CITY OF NAPOLEON

CITY OF NAPOLÉON
BUILDING DEPT.

By JEC Plan Approval
Date 10-29-81

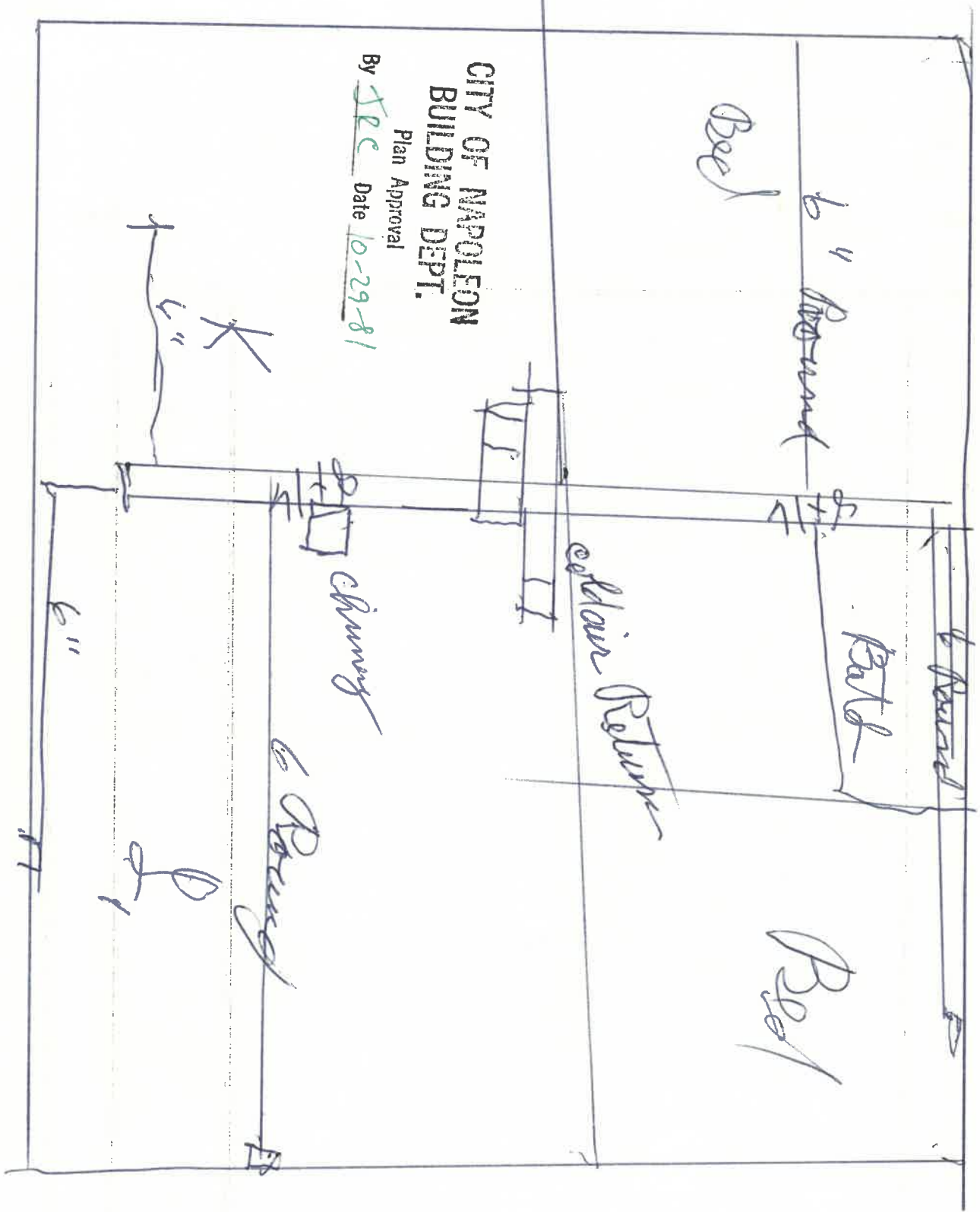

100 Nov 1-20 76

CITY OF NAPOLEON
BUILDING INSPECTION DEPARTMENT
APPLICATION FOR HEATING PERMIT
(PLEASE PRINT OR TYPE)

The undersigned hereby makes application for the installation, replacement or alteration of a heating system or device as herein specified, agreeing to do all such work in strict accordance with the City of Napoleon's adopted Mechanical Code for 1, 2 and 3 Family Buildings.

Owner's Name K.M. Lighthill Address 906 S. Perry
Contractor's Name Older Loken Address Riverside Co. Ohio Tel. 247,3573

BUILDING INFORMATION:

Single Family Double Family _____ Multiple _____ New Construction _____
Addition _____ Remodel _____ Replacement No. of Stories one

DESCRIPTION OF WORK

Heating System - Warm Air Hot Water _____ Steam _____ Electric _____

Unit Heaters _____ Unit Gas Heaters _____ Other _____

Type - Gravity _____ Forced Radiant _____

No. of Thermostatical Heating Zone one

Hot Water - One Pipe _____ Two Pipe _____ Series Loop _____

Electric Heat - No. of Circuits _____ Other _____

Total Heat Loss of Area to be Heated _____ Btu.

Rated Capacity of Furnace/Boiler 100,000 BTU Btu.

No. of Furnaces 1-55-100 No. of Hot Air Runs 6

No. of Hot Water Radiators _____ Type of Fuel _____

Heating Units Located: Crawl Space _____ Floor Level _____ Suspended _____

Roof or Exposed to Outside Air _____ Attic _____ Other Basement

APPLICATION FOR PERMIT SHALL BE ACCOMPANIED BY TWO COMPLETE SETS OF PLANS INCLUDING: LOCATION OF FURNACE OR UNIT HEATERS AND SIZE AND LOCATION OF FEEDER DUCTS AND RETURN AIR DUCTS. ALL PLANS SHALL BE DRAWN TO SCALE.

ESTIMATED COST OF COMPLETED PROJECT: 1900.00

DATE Oct 29 1981 APPLICANT'S SIGNATURE K.M. Lighthill

OWNER-CONTRACTOR-AGENT

PERMIT

CITY OF NAPOLEON, OHIO — DEPT. OF BUILDING & ZONING
255 W. Riverview Avenue, Napoleon, Ohio 43545 (419) 592-4010

Permit No. 377 Date 10-29-81
Job Location 906 S. Perry St. Valuation \$ 900.00
Address 906 S. Perry St.
Owner E.M. Lighthill Address 906 S. Perry St.
Name Eldor Gerber
Contractor Ridgevill Corners Telephone No. 267-3373
Address Ridgevill Corners
Electric Contractor _____
Plumbing Contractor Same
Mechanical Contractor _____

This permit is issued for work described in the plans, specifications, and/or application submitted, as approved by the Building Commissioner of the City of Napoleon, Ohio. Work shall conform to all pertinent construction and land use Codes and Ordinances.

Work Information:

Residential ix Commercial _____ Industrial _____
No. dwelling units
New Construction _____ Addition _____ Remodel _____
Brief Description of Work new 100,000 B.T.U. furnace, & new heat fans

ISSUED BY JRC Building Official DEPT. OF BUILDING & ZONING

It is the owners or contractors responsibility to call the Building Department for the following (x) inspections:

- Footing excavation prior to placing concrete.
- Footing drains and foundation prior to backfill.
- Prepared sub-grade prior to placing concrete floor slab.
- Sanitary sewer
- Rough-in electrical, plumbing and service framing prior to installing wall board.
- Final electrical, plumbing and heating.
- Final building inspection, prior to occupancy.

Permit is not valid until all fees are paid in full, and shall be void if work is not started within six months of date above.

PERMIT & FEES

Building Permit	\$ _____
Electrical Permit	\$ _____
Plumbing Permit	\$ _____
Mechanical Permit	\$ <u>6.00</u>
Demolition Permit	\$ _____
Zoning Permit	\$ _____
Sign Permit	\$ _____
Water Tap	\$ _____
Sewer Tap	\$ _____
Temp. Elec.	\$ _____
Other _____	\$ _____
TOTAL FEES	\$ <u>6.00</u>
LESS FEES PAID	\$ _____
BALANCE DUE	\$ _____

PAID
OCT 29 1981
CITY OF NAPOLEON

INSPECTION RECORD

UNDERGROUND		ROUGH-IN & FINA/			
Type	Date	By	Type	Date	By
PLUMBING	Sewer Connection		Drainage, W. & Vent		Drainage, W. & Vent
	Building Sewer		Water Piping		Water Heater
	Water Piping		Condensate Lines		Backflow Prevention
			Indirect Waste		
ELECTRICAL	Floor Ducts Raceways		Rough Wiring		FINAL APPROVAL
	Conduits & or Cable		Conduits/ Cable		Electric Mtr. Clearance
	Grounding & Bonding		Service Panel		Signs
			Switchboard		
			Subpanels		
			<input type="checkbox"/> Range <input type="checkbox"/> Dryer		FINAL APPROVAL
MECHANICAL	Refrigerant Piping		Refrigerant Piping		Duct Insulation
	Ducts/ Plenums		Ducts/ Plenums		Chimney(s)
			Ventilation <input type="checkbox"/> Supply		Furnace(s)
			<input type="checkbox"/> Exhst.		FINAL APPROVAL
BUILDING	Location, Set-backs, Esmt(s)		Wall Construction		Fireplace Chimney
	Excavation		Crawl Space <input type="checkbox"/> Vent <input type="checkbox"/> Access		Attic <input type="checkbox"/> Vent <input type="checkbox"/> Access
	Footings & Reinforcing		Floor System(s)		Special Insp Reports Rec'd
	Sub-soil Drain		Roof System		Smoke Detector
	Foundation Walls		Fire Wall(s)		Demolition (sewer cap)
	Floor Slab		Roof Cover. Roof Drain		Building or Structure
	FINAL APPROVAL		<i>[Signature]</i> Certificate of Occupancy issued		#
	BLDG. DEPT				